

MERKEL® WIPER P6

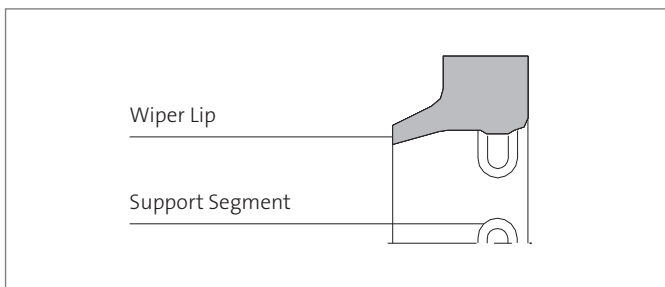

Merkel® wiper P6 is a single-acting elastomer dirt wiper with support segments to avoid twisting.



VALUE TO THE CUSTOMER

- Good seating at the outer diameter
- Very good wiping performance
- Wiper can be used in a wide temperature range
- No twisting in the housing and no pressure build-up between seal and wiper

Applications

The P6 dirt wiper is principally used in the large diameter range of standard applications.

Material

Material	Designation	Color
Nitrile rubber	85 NBR B247	black
Fluoroelastomer	85 FKM K664	reddish-brown



TECHNICAL PROPERTIES AND INSTALLATION

Operating Conditions

Material	85 NBR B247	85 FKM K664
Hydraulic Oils, HL, HLP	-30 ... +100 °C	-10 ... +200 °C
HFA Fluids	+5 ... +60 °C	+5 ... +60 °C
HFB Fluids	+5 ... +60 °C	+5 ... +60 °C
HFC Fluids	-30 ... +60 °C	-
HFD Fluids	-	-10 ... +200 °C
Water	+5 ... +100 °C	+5 ... +80 °C
HETG (rape-seed oil)	-30 ... +80 °C	-10 ... +80 °C
HEES (synth. ester)	-30 ... +80 °C	-10 ... +100 °C
HEPG (glycol)	-30 ... +60 °C	-10 ... +80 °C
Mineral Greases	-30 ... +100 °C	-10 ... +200 °C
Sliding Speed	2 m/s	2 m/s

The figures given are maximum values and must not be applied simultaneously.

Design Notes

Please note our general design-related remarks in our technical manual.

Installation Diagram

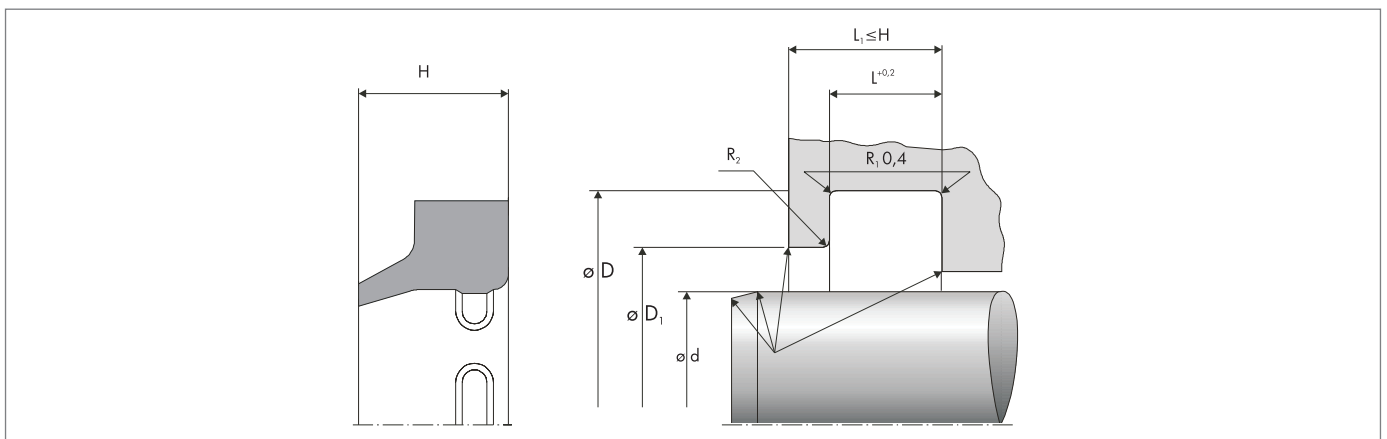

The information contained herein is believed to be reliable, but no representation, guarantees or warranties of any kind are made to its accuracy or suitability for any purpose. The information presented herein is based on laboratory testing and does not necessarily indicate end product performance. Full scale testing and end product performance are the responsibility of the user.

Surface Finish

Peak-to-valley heights	R_a	R_{max}
Sliding surface	*	*
Groove base	$\leq 1,6 \mu\text{m}$	$\leq 6,3 \mu\text{m}$
Groove sides	$\leq 3,0 \mu\text{m}$	$\leq 15,0 \mu\text{m}$

Material content M_r > 50% to max. 90%, with cut depth $c = R_z/2$ and reference line $C_{ref} = 0\%$.

* Surface roughness of the sliding surface to suit the sealing component used.

Tolerance Recommendation

Nominal- ϕ d [mm]	D	D_1
16 ... 2,900	H10	H11

The tolerance for the diameter d is determined by the buffer seal.

Installation Chamfers

Length and angle must be executed to suit the rod seal being used.

Installation & Assembly

Careful installation is a prerequisite for the correct function of the wiper P6. Generally, wipers can be quickly and easily fitted by deforming into a kidney shape. Please note the general remarks on the installation of hydraulic seals in our Technical Manual, assembling hydraulic seals.